

PLANTA PISO 1
Área Bruta = 88.70 m²

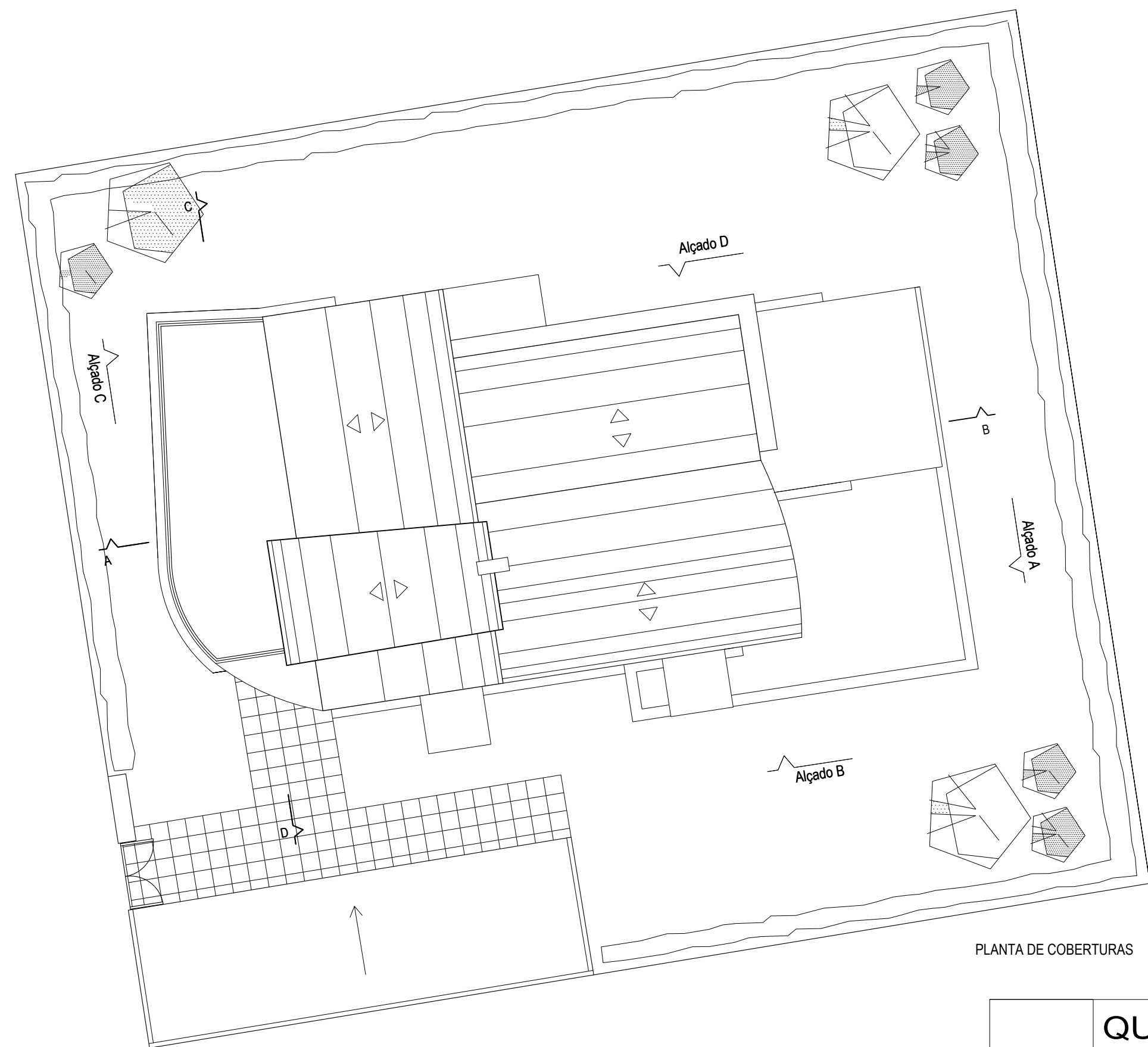

PLANTA DE COBERTURAS

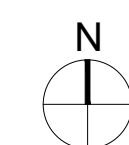

QUINTA DO ANJO - PALMELA VILLAGE

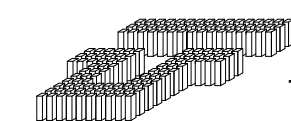

TOMÁS TAVEIRA S.A.



Pelicano

Investimento Imobiliário, S.A.
RUA JULIETA FERRÃO Nº 12 TORRE A 11º PISO
1600-131 LISBOA - Tel. 217826440 - Fax 217826450

LOTE 34-7 MORADIA I2

Desenho: PLANTAS DO PISO 1 e COBERTURA

3

OSS.:

Escala: 1/100

Data: JANEIRO 2003